

M/V Venturer

SHIP TYPE	Seismic research vessel
CLASSIFICATION	Det Norske Veritas
BUILDER	1986 Drammen, Norway
PORT OF REGISTRY	Bergen
FLAG	Norwegian
IMO NUMBER	8510673
CALL SIGN	LAZD5

OWNER: Østervold Seismikk AS
N-5384 TORANGSVÅG

MANAGER: VESTLAND MANAGEMENT AS
N-5384 TORANGSVÅG

MAIN DIMENSIONS

Length O.A	89,55 M
Breadth	14,40 M
Max Draft	6,4 / 4,975 m (summer)

CLASS NOTATIONS

+1A1 HELDK



OUTLINE SPECIFICATION

MACHINERY AND PROPELLER PLANTS

Main Engines: 3 x 1826 kW/2480 HP Bergen Diesel
2 of them in dir. Prop. with max 4961 HP
Alternative propulsions: In electrical mode max 1100kW
Bow Thrusters: Brunvoll, electrical 670 HP / 500kW

NAVIGATION

GPS: Shipmate RS5310
Furuno GP80/GR80 DGPS
Gyro Compass: SG Brown Meridian
Radar: 10 cm Furuno FAR2835S
3 cm Furuno FAR 2827
Autopilot: Robertson AP9 MkII
Robertson Robtrack
Speed Log: Sal SD 1-7
Echo sounder: Skipper GDS 101
ECDIS: Admiral
Wind Indicator: Analogue, Thomas Walker
Magnetic compass: Bergen Nautic

COMMUNICATION

Safety: GMDSS A1, A2 and A3
Satellite VSAT: Saturn 3S, JRC Marine, VSAT DMS
Data Transfer: 64 kb/sec Marine Network
128 kb/sec Seismic Network
VHF Radio Stationary: 1 x Sailor RT 2047
2 x Kelvin Hughes 2042
1 x Sailor RT 4822
VH Radio Portable: 2 x Motorola
2 x ICOM
MF/HF Radio: Skanti TRP8751D, 750 watt
Skanti TRP8000D, 750 watt
Navtex Receiver: Furuno MX – 500
VSAT: TBA
Inmarsat C: 2 x Thrane and Thrane TT3020C
Inmarsat M: TBA
Vessel E-mail: TBA@vestlandoffshore.no

ACCOMMODATION

Safe Manning cert: 10 persons
Cabin Type 1: 26 Single cabins
Cabin Type 2: 8 Double cabins
Cabin Type 3: Hospital – 1 Bed not be counted
Total: Total safe capacity – 50 (certif)

SAFETY EQUIPMENT

MOB Boat: Norsafe 6.55 Marko FRC
Life Rafts: Viking 6 x 25 persons
MOB liferaft – 4 persons
Life Vests: 99 pcs
Work Vests: 10 pcs
Survival Suits: 56 pcs
Seismic Workboat: Molo Norpower 22

LIFTING APPLIANCES

Cargo Crane: ABAS 5 ton/16 meters
Provision Crane: Hydralift 2 ton

SPEED

Cruising Speed: 13 knots

HELIDECK

Rating: Bell 212
Fire Fighting: Foam system and 50kg dry powder
Helicopter deck rating: 9300kgs
Non directional beacon: Jotron 30S
Ship/Air Communication: Skanti TRP800 HF-SSB
Motion Weather Info: TSS DMS2

OPERATION

Fuel Capacity: 600 m³ with tanks full
Endurance: 35 days in production
Fuel Consumption: 18 m³ / day (transit economic)
15 m³ / day (3D Operations)
12 -13 m³ / day (Source mode)
Fresh Water: 142 m³
35m³ / day produced by reverse osmosis
Bollard Pull: From 680kN to 200 kN at 10kt

SEISMIC EQUIPMENT

Seismic Compressors: 8 x Hamworthy, 390 SCFM @ 2000 psi
Source Type: Bolt 1500LL and 1900LLXT
Number of Strings: 6 Max
Number of Winches: 6
Gun Controller: SEAMAP Gunlink 2000
Tow System: Baro flexible gun floats
Streamer: 4 X 6000m Sercel Seal, Fluid streamer,
Digital 24 Bit
Hydrophone Type: Benthos Geopoint / Vinci NH 95-200
Winches: 4 Winches 8000m capacity
Deflector: Baro 43
Cable Lever: DigiCOURSE Model 5011 Compass Bird
Heading Sensor: DigiCOURSE Model 321
Acoustic System: Sonardyne SIPS2
In Water Unit: XSRS for Streamer, HGPS for Source
Tailbuoy: Partnerplast, Seatrack 220 RGPS
Acoustic on Guns Arrays: Seatrack 320
RGPS: Sonardyne SIPS2 HGPS, One per gun float
Processing Platform: 8 x Dell 1950 processing and host nodes. 2 x
SuperMicro tape servers. 3 x Dell xw4600
processing workstation. 93 virtual CPUs
physically consisting of 20 Intel Xeon Quad
Core (16 x 2.83GHz, 4 x 2GHz). 6 Intel Core
Duo (6 x 3GHz). 1 Intel Pentium 4 (3GHz).
The processing power is adequate for
comprehensive acquisition QC and full
prestack processing with Fast Track
NMO/Stack or final DMO/Stack and post stack
migration.
Tape Drivers: 4 x IBM 3590E
Processing Software: Tango

WORKBOATS

Type: NORPOWER 22FT
Length O.A.: 6,95 m
Beam: 2,47 m
Draught: 1,10 m
Weight (4 crew): 4400 kg
Engines: John Deer 6068 180hp 2400rpm
Bollard Pull: 2000kg
Fuel: 240L Diesel
Max Speed: 16kt

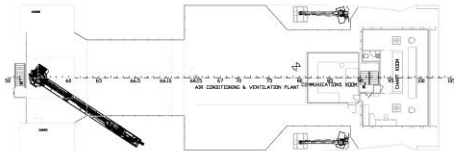
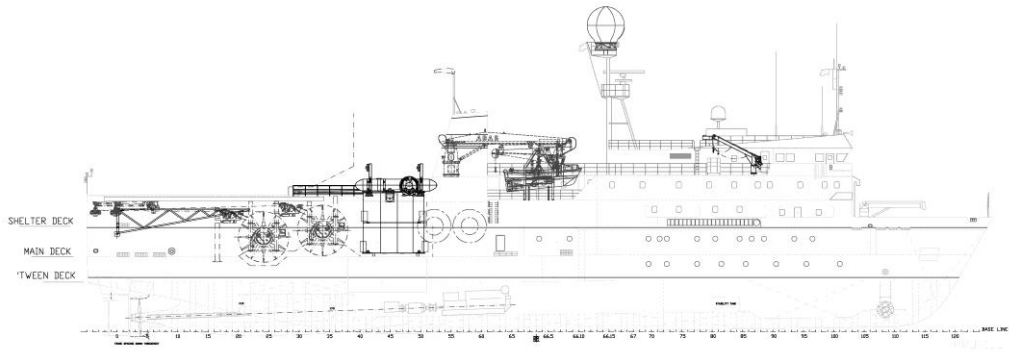

BRIDGE DECK

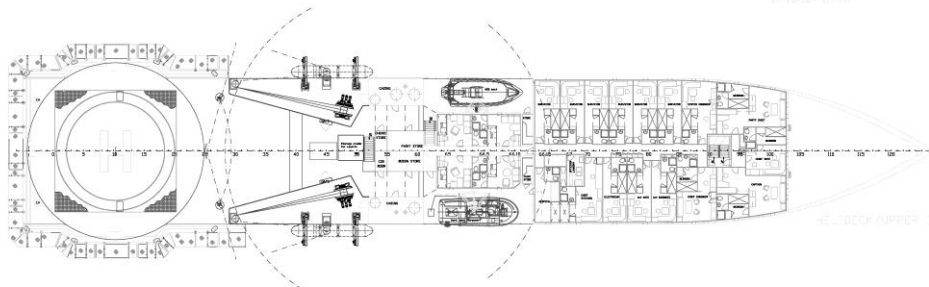

HELICOPTER DECK UPPER DECK

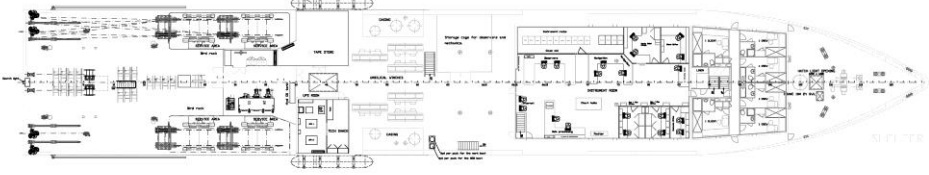

SHELTER DECK

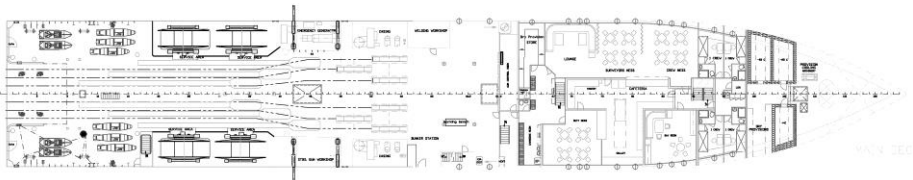

MAIN DECK

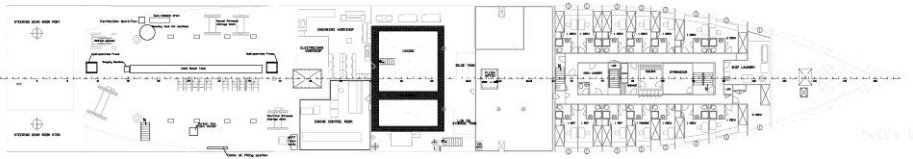

TWEEN DECK

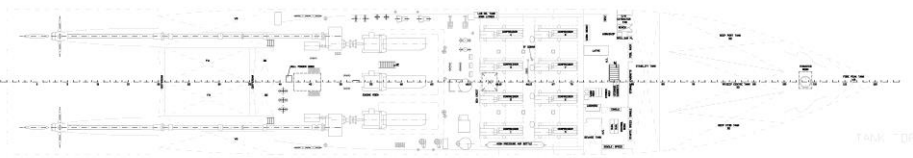

TANK TOP

PRINCIPAL PARTICULARS

LENGTH OVERALL	83.50M
LENGTH BP	66.50M
BREADTH MLD	14.40M
DEPTH MLD TO DECK	7.20M
DEPTH MLD TO SHELTER DECK	10.0/10.5M
DEPTH ON DECK	5.97M

GENERAL ARRANGEMENT		1:150	DR	05.05.08
500 VENTURER		AO		
				S285/06-034
C924				

